

SCITUATE COMMUNITY PRESERVATION COMMITTEE

Fiscal 2010 APPLICATION FOR FUNDING

Project Name: Groveland Cemetery National Register Nomination

CPA funding requested: \$ 5,000. (REQUIRED)

Total project cost: \$ 5,000. (REQUIRED)

Other Funding Sources Applied For/Obtained:

Grants: \$ Applied For Obtained

Other (describe) \$ Applied For Obtained

Basis for project cost (i.e. appraisal, construction estimate, etc. - please attach all documentation supporting estimated project cost and basis)

Category (check all that apply): Open Space X Historical Housing Recreation

- Lot and Plat: *
Assessors Map #: *
Number of acres in parcel: *
Number of proposed housing units: *
Current Zoning Classification: *

Name of Applicant: Groveland Cemetery Association

Contact Name: Cynde Robbins

Address: 292 Clape Rd, Scituate, Ma, 02066

Phone: 781-545-4167 E-Mail: Cynde.Robbins@Comcast.net

By signing below, the Applicant agrees to the terms and conditions and all other requirements of this Application and agrees to be bound thereby if funding is granted for the Project.

Applicant's Signature: Wayne H. Robbins Date: 10-29-09
Printed Name: Wayne H. Robbins
Title: President

Vertical stamp: OCT 30 A 10:02

Groveland Cemetery National Register Nomination

The Groveland Cemetery Association, a 501c3 nonprofit corporation established in 1884, is requesting funding to place the Groveland Cemetery for nomination to the National Register of Historic Places. Groveland Cemetery is located off Mann Lot Road just up the hill from Country Way and the First Baptist Church.

We feel that a National Register listing will help us to secure grant funding in the future to repair and stabilize the broken monuments in our cemetery. We would also like to computerize our records so they can be made available for people researching genealogy. The Groveland Cemetery Association has very limited funding which is all dedicated to perpetual care of the grounds so grants will have to be secured to accomplish the preservation work.

Groveland Cemetery dates to the late 1600's and as you stroll through the grounds you will see many old Scituate names: Gannett, Litchfield, Bailey, Modcai Lincoln, Gridley Bryant, Clapp, Vinal, Bates, Turner, Merritt, and Damon to mention just a few. We have included the Burial Sites Survey section and the Form-E from the PAL report as documentation that Groveland Cemetery is eligible for listing in the National Register under Criteria A and C and possibly D.

This project supports the Town's CPA goals for historic resources. Specifically Goal 3 states "recognizing , preserving and enhancing the historic heritage and character of the Town of Scituate for current and future generations".

The estimated cost to complete the National Register Listing is \$5,000. This money would be used to hire a preservation consultant to prepare and submit the National Register Listing application. We intend to work with Doug Smith and the Historical Commission on this project and will start as soon as funding is available in 2010.

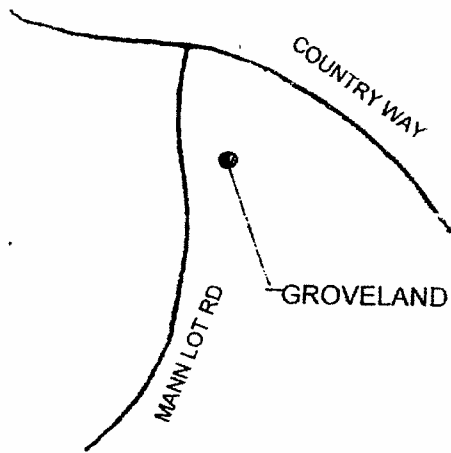

GROVELAND CEMETERY

Mann Lot Road, North Scituate
c. 1700

Historical Development

The origins of Groveland Cemetery date to the late 17th century, when the Conihassett partners laid out a burying place between the land of Thomas Hiland and John Pierce (1699).

Of the many gravestones from the early 1700s, is the gravestone of Mordecai Lincoln (1656- 1727), great, great, great grandfather of President Abraham Lincoln. Gridley Bryant, builder of the first railroad in the US is also buried at

Groveland. The receiving tomb located near the northern entry drive was built in 1853.

A survey of the cemetery prepared in 1894 and updated in 1911 shows that plans for the cemetery were never fully executed. The drawing shows the existing road network, but extends the southern roadways along the full extent the property line. The eastern eighth of the cemetery remains undeveloped as planned. The cemetery is owned and maintained by the Groveland Cemetery Association, and still accepts burials. The association is in the process of expanding burial sections on the north side of the cemetery.



Assessment

Groveland Cemetery is tucked into the east side of Mann Lot Road near its intersection with Country Way in North Scituate. Of all the town's burial sites, Groveland contains the most diverse landscape – one that spans nearly three hundred years – and reflects many different historic cemetery styles. Its shape is long and rectangular, fronting the road with nearly 350 feet, and stretching eastward, away from the road by over 1,000, covering over nine acres. The cemetery core reflects a Colonial style of burial with single graves of unrelated individuals placed alongside one another. Radiating out from the core are family plots, surrounded by copings and marked with central obelisks, typifying the Victorian style. Along the northern edges are standard 30" markers, reflective of a more contemporary, 20th century style of burial.

Visitors enter via one of three gates – two along Mann Lot Road or a back entrance at the northeast corner. The cemetery roads remain unpaved and are covered with either turf, or a combination of turf and dirt. A diverse mix of tree species, including hemlocks, maples, cedars, horse chestnuts and lindens, shades much of the landscape. An outstanding European beech, roughly 60" in caliper, stands nearly at the cemetery's center, and several outcroppings of granite punctuate the lawns. The caretaker has reserved an area along the northern border for disposal of grave spoil, and stores tools and excavating equipment in a Gothic Revival style shed at the western end (near the entrances off Mann Lot Road). The cemetery is screened from residences on the north, east and west sides from by hedgerows of deciduous trees.

The cemetery contains many structural elements, adding detail to the landscape. A mortared stone wall lines the cemetery edge along Mann Lot Road, and stone gateposts flank both the Mann Lot and Studley Road entries. A dry-laid fieldstone wall rims most of the perimeter and granite curbing surrounds several family plots. The cemetery contains two tombs – a mortared cut granite mound tomb (“receiving tomb”) and a private underground tomb. A wood frame hearse house, built in the Carpenter Gothic style stands near the Mann Lot Road entrance. The condition of these structures ranges from good (entry gates and hearse house), to fair (Mann Lot Road wall and receiving tomb), to poor (perimeter fieldstone wall and family plot curbing). The condition of the underground tomb is unknown.

Groveland Cemetery contains a broad mix of grave markers, both old and new and including many large granite monuments. The older graves lie in the central portion of the cemetery and include the burial sites of numerous veterans of past wars, including the Revolutionary War. Among the older graves is a superb collection of early eighteenth century slate markers, crafted by known carvers. Included is some of the best work of the Soule Shop, Bildad Washburn, Jacob Vinal, Jr., and others. Mowing around these markers has resulted in heavy scratching, as well as broken, tilted and fragmented stones. Groveland also contains many markers made of marble and granite. Many of the slate, marble and granite markers are in need of cleaning, resetting, and/or extensive conservation repair.

Recommendations

- **Structures.** The town should make repairs to all the structures, giving priority to those in the poorest condition. Volunteer trees growing in and adjacent to the perimeter wall should be removed and the stones reset. The poorest sections of wall should be reconstructed altogether. The family plot curbing, along with the soil supporting it should be removed, reset and pinned, and the soil replaced with light weight backfill material. The Mann Lot Road wall should be stabilized by removing soil behind shifting portions of the wall, and replacing it with gravel backfill. The receiving tomb should be restored by removing the soil behind the headwall and failed portions of the adjacent retaining wall, and replacing the soil with gravel. The headwall and retaining walls should then be reset, and an historically accurate doors hung in place of the existing steel doors. The gateposts should be cleaned and the cast iron gate painted. Vegetation should be removed from the foundation of the hearse house, the foundation (back left corner) should be repaired, and the entire structure should be cleaned and painted, with any rotted wood replaced. For more detailed treatments of the various structures at Groveland Cemetery, refer to *Appendix A: Engineering Assessment*.
- **Gravestones.** The *Gravestone Assessment* identified 119 slate markers and 155 granite and marble markers in need of conservation treatment. The town/trustees should make an effort to conserve these and, at the same time, amend the caretakers' current practices of mowing close to the markers. In addition, the town/trustees should complete a detailed inventory of the slate markers, including a record of information found on each stone, as a means of further documenting Scituate's history.
- **Roadways.** The turf and/or dirt surfaces of the roadways reflect the historic character of the cemetery and the town/trustees should retain them. In areas where erosion occurs or low spots emerge, the town/trustees should add compacted gravel, and cover it with 6" of topsoil and seed. This will create a “reinforced turf” surface - one that will withstand the weight of a car or truck, but retain the historic look of turf.

- **Trees.** Many of the cemetery trees are very mature and will likely reach the end of their lives with the next twenty years. The town/trustees should plan for this by (1) removing any diseased or dying trees immediately before they harm the health of other trees, (2) remove the damaged or dead limbs of healthy trees, to encourage a longer life, and (3) introduce new trees to eventually replace the dying ones. These new plantings should reflect a variety of species. Refer to the *Burial Site Management* section of this plan for a list of appropriate tree plantings.
- **Maintenance Area.** Currently, the trustees store equipment in the Gothic Revival hearse house, and park maintenance vehicles (such as the backhoe), alongside the hearse house. The building blends with the historic character of the cemetery, but the backhoe and other equipment do not. The town/trustees should consider relocating the hearse house and equipment to a central maintenance area - outside the center of the cemetery - where equipment and other maintenance tools can be screened from the larger landscape. The existing grave spoil area, located along the northern border, is an ideal location for both the hearse house and equipment - centrally located but away from the loveliest parts of the cemetery landscape.
- **Grave Spoil.** Grave spoil has been haphazardly piled along the northern border, and remains visible to visitors. The town/trustees should address this area by (1) screening the grave spoil with fencing in combination with the hearse house, and/or (2) using the grave spoil for grading in the new, undeveloped sections of the cemetery, along the eastern edge.
- **Signs.** The town and trustees should place interpretive signs at the entrances to the cemetery, noting its name, its importance to the history of Scituate, and the rules and regulations for visits to the cemetery. The roadways within the cemetery were named (likely in the 19th century) and signs noting these names would provide additional guidance to visitors.
- **Cemetery Records.** Currently, the Groveland Cemetery burial records exist in a variety of formats, including files, cards, and notebooks. None of the information corresponds to a map. To insure that the records remain safe, the town/trustees should make an effort to organize the data into a single database, link the database to a map, and make multiple copies of the both the database and map.

FORM E - BURIAL GROUND

Assessor's number

20/3/00A

USGS Quad

Cohasset, MA

Area(s)

Form Number

SCI.801

Massachusetts Historical Commission
Massachusetts Archives Facility
220 Morrissey Boulevard
Boston, Massachusetts 02125



Sketch

set

in Scituate

ne (neighborhood or village)

Address or Location Mann Lot Road

Name: Groveland Cemetery

Ownership Public Private

Approximate Number of Stones 300

Oldest Death Date early 18th century

Newest Death Date late 20th century

Landscape Architect

Condition good to excellent

Size 5.27 acres

Setting rolling terrain with trees and winding paths

Recorded by Joanna Doherty, Jonathan Mekinda

Organization PAL

Date (month/day/year) March 2000

BURIAL GROUND FORM

Community: Scituate
Address: Mann Lot Road

VISUAL/DESIGN ASSESSMENT

The Groveland Cemetery is located on approximately five acres of grassy, slightly rolling terrain in North Scituate. On its western edge, the property is bordered by Mann Lot Road, which separates the cemetery from conservation land owned by the town of Scituate. To the north, east, and west, the cemetery abuts house lots located along Studley Royal, Country Way, Pratt Road, and Bishop's Lane. Stone walls delineate the cemetery's boundaries, and the entrance off of Studley Royal is marked by stone piers. The cemetery includes winding paths and is dotted with mature trees.

Groveland Cemetery includes approximately 300 grave markers, the earliest of which dates from the early eighteenth century. Many arch-shaped headstones are present, and eighteenth-century motifs include winged cherubs and skulls. Some stones include rosettes that are typical of the work of Jacob Vinal (1719-1764), a Scituate native and noted gravestone carver. Nineteenth century forms include pointed-arch-top stones and obelisks, and many markers include the common nineteenth-century funerary motif of a willow and urn. Newer grave markers include simple granite stones with smooth and rusticated finishes, dating from the late-nineteenth century to the present day. While some of the older stones are illegible or broken, the majority remain readable. The cemetery contains headstones dating from at least as early as 1738, and includes members of many early Scituate families, including the Lincolns and Studleys. Groveland Cemetery also includes a small, Gothic Revival-style chapel. The 1-story, front-gable, rectangular building features board and batten siding; filled-in, pointed arch windows; and decorated vergeboards at its gables.

HISTORICAL NARRATIVE

Sources indicate that Groveland Cemetery was established around 1699, to serve as a burying ground for the northern part of Scituate (Deane 1831:116). This section of town was included in the Conihasset Grant, a parcel of land that was granted to a group of people who formed the "Conihasset Partners" in 1637, one year after Scituate was incorporated as a town (DAR 921:2; Bangs 1999). A map showing the boundaries and features of the Conihasset Grant includes "The Burying Place" located in approximately the same location as the present-day Groveland Cemetery (Bangs 1999). This is likely the same burial ground mentioned in Samuel Deane's *History of Scituate, Massachusetts* as having been established by the Conihasset Partners in 1699. Deane writes that, at the time of the book's 1831 publication, "this is now used by many families in the north-west part of the Town" (Deane 1831:116). Mordecai Lincoln (1651-1738), the great, great, great grandfather of Abraham Lincoln, who established a sawmill on Bound Brook around 1690, is buried here, as is Gridley Bryant, the builder of the first railroad in the United States (MHC 801; DAR 1921:136-137). The cemetery also contains a large marker for the Studley family, several branches of whom settled in the Scituate area in the seventeenth and early eighteenth centuries (Deane 1831:339-340). The cemetery is clearly indicated, though un-named, on a map from 1903, and is labeled as the Groveland Cemetery on a 1930 map of the town (Anonymous 1903; Bailey 1930). Owned by the Groveland Cemetery Association, the cemetery continues to accept burials.

BIBLIOGRAPHY and/or REFERENCES

- Anonymous. *Directory and History of Scituate, Mass., 1894*. J.H. Hogan Company, Quincy, MA, 1894.
Anonymous. *Scituate, 1636-1961*. Scituate Chamber of Commerce, 1961.
Anonymous. "100 year Old Photo Inspires Art Association." *The South Shore News*. March 28, 1973.
Bailey, Henry Turner. *Yankee Notions*. Washburn & Thomas, Cambridge, MA, 1929.
Bailey, Sarah Tilden. *The First Baptist Church*. The Boundbrook Press, Scituate, MA, 1913.

Recommended for listing on the National Register of Historic Places. If checked, you must complete a National Register Criteria Statement.

INVENTORY FORM CONTINUATION SHEET

Community:

Scituate

Property Address:

Mann Lot Road

Massachusetts Historical Commission

Massachusetts Archives Facility

220 Morrissey Boulevard

Boston, Massachusetts 02125

Area(s)

Form No.

- Bangs, Jeremy Dupertuis. *The Seventeenth-Century Town Records of Scituate, Massachusetts*. 2 vols. New England Historic Genealogical Society, Boston, MA, 1999.
- Bonney, Margaret Cole. "My Scituate." n.d. On file, Scituate Public Library.
- Bonney, Margaret Cole. *Scituate's Sands of Time*. Ca. 1988. On file, Scituate Public Library, Scituate, MA.
- Brengle, Kim Withers and Betsy Friedberg. *National Register of Historic Places Inventory - Nomination Form, Woodworth House, Scituate, MA*, 1996.
- Briggs, Lloyd Vernon. *History of Shipbuilding on North River, Plymouth County*. Coburn Brothers, Boston, MA, 1889.
- Daughters of the American Revolution (DAR). *Old Scituate*. DAR, Chief Justice Cushing Chapter, Boston, MA, 1921.
- Deane, Samuel. *History of Scituate, Massachusetts: From the First Settlement to 1831*. James Loring Publisher, Boston, MA, 1831.
- Dixon, Mila Bates. "Worth Mentioning: Henry Turner Bailey had the best home office." *The Scituate Mariner*, December 12, 1996.
- Ellis, Katherine. *The History of Ellsberg*. ca. 1940. On file, Scituate Public Library, Scituate, MA.
- Freymann, Jarvis. *Scituate's Educational Heritage: 1630-1990*. Scituate Historical Society, Scituate, MA, 1990.
- Howard, Harold. *Towns of Scituate and Marshfield, Massachusetts Directory*. Harold Howard, Boston, MA, 1926.
- Howe, Henry. *Early Explorers of Plymouth Harbor, 1525-1619*. Plimoth Plantation, Inc. and the Pilgrim Society, Plymouth, MA, 1953.
- Humphrey, Thomas J. and Norton D. Clark. *Boston's Commuter Rail: The First 150 Years*. Boston Street Railway Association, Boston, MA, 1985.
- Hurd, D. Hamilton, editor. *History of Plymouth County, Massachusetts*. J. W. Lewis, Philadelphia, PA, 1884.
- Irwin, Will. *Scituate, 1636-1936*. Scituate Tercentenary Committee, Scituate, MA, 1936.
- Kubie, Kathryn and Margo B. Webber. *National Register of Historic Places Inventory - Nomination Form, Captain Benjamin James House, Scituate, MA*, 1983.
- League of Women Voters. *About Our Town*. League of Women Voters, Scituate, MA, 1955.
- Lincoln, Charles C. *Old Roads of Scituate*. 1950-51. On file, Scituate Public Library.
- Lincoln, Charles C. *Topology of Land Marks [Scituate]*, 3 vols. 1950-51.
- Local History Collection. Scituate Public Library, Scituate, MA.
- Massachusetts Historical Commission. *Historic and Archaeological Resources of the Commonwealth*. Massachusetts Historical Commission, Boston, MA, n.d.
- Inventory Forms: Scituate, MA. On file.
- Maker Index, December 1999. On file.
- Reconnaissance Survey Report: Scituate, Massachusetts*. Massachusetts Historical Commission, Office of the Secretary of State, Boston, MA, 1982.
- Merritt, Joseph Foster. *Old Time Anecdotes of the North River and the South Shore*. Rockland Standard, Rockland, MA, 1928.
- Miles, Margaret. *Notes on the Ellis Property*. 1972. On file, Scituate Public Library, Scituate, MA.
- Mills, Jeanne. "This May the Pierce Memorial Library Will Be Eighty Years Old." *The South Shore News*, April 3, 1974.
- Murphy, Barbara. *Scituate: The Coming of Age of a Plymouth County Town*. No publisher, 1985. On file, Scituate Public Library, Scituate, MA.
- Pratt, Harvey Hunter. *The Early Planters of Scituate*. Scituate Historical Society, Scituate, MA, 1929.
- Scituate Historical Society. *The Cudworth House, Stockbridge Mill, and Other Places Of Historic Interest*. Scituate Historical Society, Scituate, MA, 1966.
- Scituate Scrapbooks. On file, Scituate Public Library, Scituate, MA.

INVENTORY FORM CONTINUATION SHEET

Community: Scituate
Property Address: Mann Lot Road

Massachusetts Historical Commission
Massachusetts Archives Facility
220 Morrissey Boulevard
Boston, Massachusetts 02125

Area(s)
Form No.

- Town of Scituate. *List of Persons Twenty Years of Age and Older Residing in Town of Scituate on January 1, 1936.* Sanderson Brothers, North Abington, MA, 1936.
- Town of Scituate. *Persons Assessed For Poll Tax in the Town of Scituate, April 1, 1924.* On file, Commonwealth of Massachusetts State Library, Boston, MA, 1924.
- Town of Scituate. *Valuation List, 1927.* On file, Scituate Public Library, Scituate, MA.
- United States Bureau of the Census. *Population Figures. 1790-1980.*
- Vertical files -- "Churches," "Greenbush," "Historic Landmarks," "Houses," "Scituate People." On file, Scituate Public Library, Scituate, MA.

Maps

- Anonymous. *Atlas of Plymouth County, Massachusetts.* Geo. H. Walker & Co., Boston, MA, 1879.
- Anonymous. *Map of Scituate in 1640.* On file, Scituate Historical Society, Scituate, MA.
- Anonymous. *Map of Settlement of "Men of Kent" Scituate 1633.* In Anonymous, *Scituate, 1636-1961.* Scituate Chamber of Commerce, 1961.
- Anonymous. *Town of Scituate, Mass, 1879.* On file, Scituate Historical Society, Scituate, MA.
- Anonymous. *Village of Scituate; Town of Scituate; Minot Post Office, 1903.* On file, Scituate Public Library.
- Bailey, Frederic T. *Historical Map of the Town of Scituate, 1930.* On file, Scituate Historical Society, Scituate, MA.
- Bangs, Jeremy Dupertuis. *The Conihasset Grant.* In Bangs *The Seventeenth-Century Town Records of Scituate, Massachusetts.* 2 vols. New England Historic Genealogical Society, Boston, MA, 1999.
- de Barres, Joseph F.W. et al. *The Atlantic Neptune Series.* Ca. 1774-1781. On file, Scituate Historical Society, Scituate, MA.
- Richards, L. J. & Co. *Town of Scituate, Atlas of Plymouth County, 1903.* On file, Scituate Historical Society, Scituate, MA.
- Robbins, A. and S. A. Turner. *Map of Scituate, Massachusetts.* Pendelton's Lithography, Boston, MA, 1831.
- Sanborn Map Company. *Scituate, Massachusetts, Plymouth County.* Sanborn Map Company, New York, NY, 1908; 1918; 1926; 1939; 1944.
- Scituate Planning Board. *Street Map of Scituate, Massachusetts.* Scituate Planning Board, Scituate, MA, Sept. 1952.
- Turner, Charles. *A Plan of the Town of Scituate, 1795.* On file, Massachusetts State Archives, Boston, MA.
- Walling, Henry F. *Map of the County of Plymouth: Scituate Harbor and Scituate Centre.* D.R. Smith & Co., Boston, MA, 1857.
- Walling, H.F. and O.W. Gray. *Official Topographic Atlas of the State of Massachusetts.* Brown & Lyon, Boston, MA, 1871.

NATIONAL REGISTER OF HISTORIC PLACES CRITERIA STATEMENT

Groveland Cemetery is eligible for listing in the National Register of Historic Places under Criteria A and C at the local level in the areas of community planning and development and art. Under Criterion A, the property possesses significance as an early burial ground in Scituate, having been established by the Conihasset Partners, a group of early settlers, around 1699. The property meets the eligibility requirements under Criterion C for its exceptional collection of grave art spanning three centuries. Examples include winged cherubs and skulls; weeping willows and urns; and obelisks. Groveland Cemetery meets Criteria Consideration D as a property that derives its primary significance from its distinctive design features and its association with the community's early period of settlement. The cemetery possesses integrity of location, design, setting, materials, workmanship, feeling, and association. Additional historical research will be required to complete the nomination.

INVENTORY FORM CONTINUATION SHEET

Community:
Scituate

Property Address:
Mann Lot Road

**Massachusetts Historical Commission
Massachusetts Archives Facility
220 Morrissey Boulevard
Boston, Massachusetts 02125**

Area(s)

Form No.

PHOTOGRAPHS

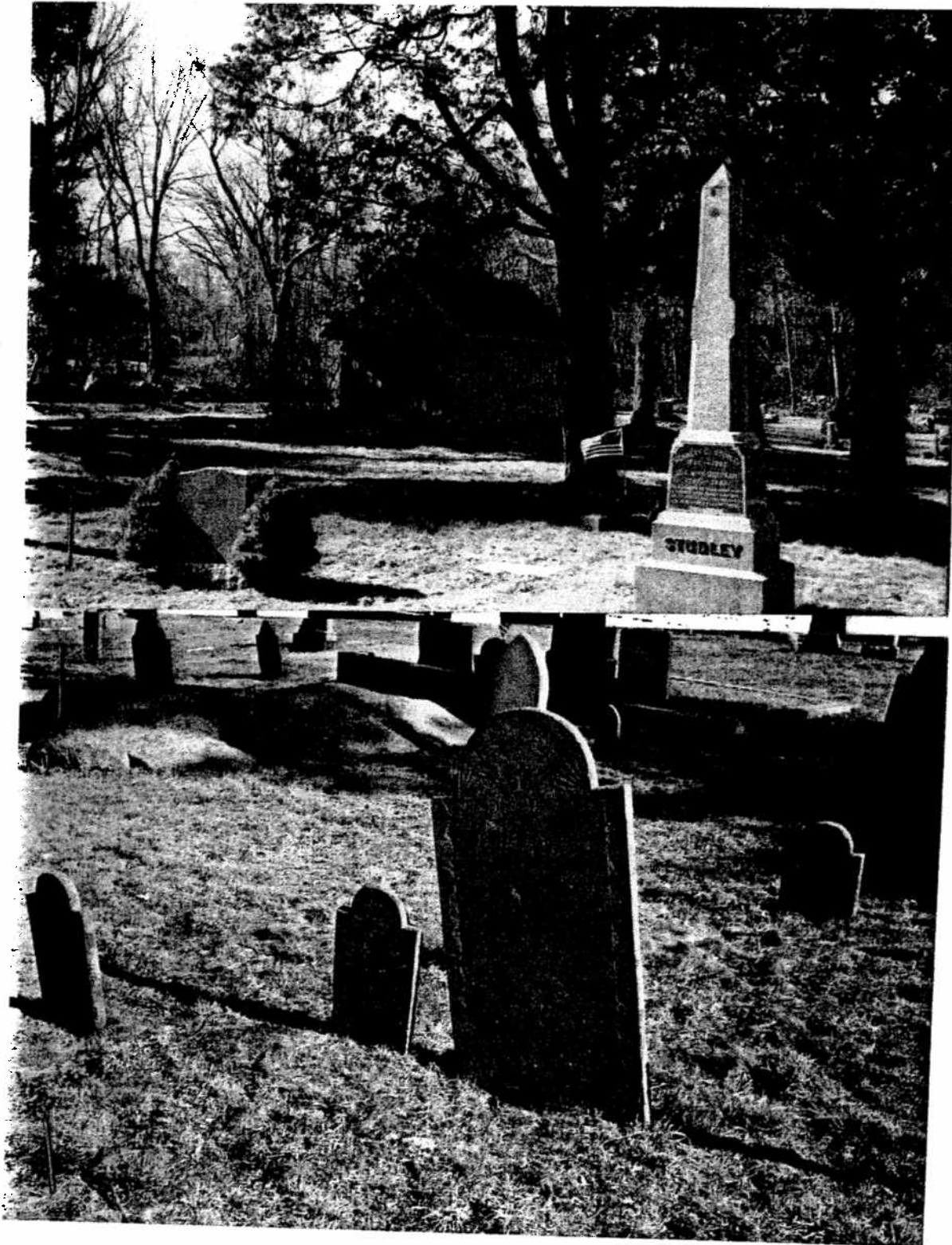

INVENTORY FORM CONTINUATION SHEET

Community:
Scituate

Property Address:
Mann Lot Road

**Massachusetts Historical Commission
Massachusetts Archives Facility
220 Morrissey Boulevard
Boston, Massachusetts 02125**

Area(s)

Form No.

PHOTOGRAPHS





GANNETT ROAD

GANNETT ROAD

GANNETT ROAD

TOWN OF SCITUATE

SCITUATE

GROVELAND CEMETERY

SCITUATE ROAD

TOWN OF SCITUATE

TOWN OF SCITUATE CONSERVATION

Groveland Cemetery
Mann Lot Road

STUDLEY ROYAL

SCITUATE ROAD

SCITUATE ROAD

SCITUATE ROAD